

USER MANUAL

LOW RESISTANCE METER

MMR-640

MMR-640



Power socket

Measurement terminal I_2

Measurement terminal I_1

Measurement terminal U_2

Measurement terminal U_1

- Dual USB A socket for connecting flash memory
- USB socket (type B) for connecting to a PC

Touch screen

START STOP

MMR-640

Meter power supply on/off button

Rechargeable batteries compartment

Measurement start/stop button



LOW RESISTANCE METER

MMR-640

USER MANUAL



**SONEL S.A.
Wokulskiego 11
58-100 Świdnica, Poland**

Version 1.03 27.02.2020

Thank you for purchasing our low-resistance meter. MMR-640 is a modern, high-quality measuring device, which is easy and safe to use. Please acquaint yourself with this manual in order to avoid measuring errors and prevent possible problems in operation of the meter.

CONTENTS

1 Safety	5
2 General Settings - menu	6
2.1 Meter Settings	6
2.1.1 Energy saving	6
2.1.2 Sound settings	7
2.1.3 PIN code settings	8
2.1.4 Display brightness settings	8
2.2 Memory settings	9
2.2.1 Memory management	9
2.2.2 Object types database	10
2.2.3 Object names database	11
2.2.4 Resistance limits database	12
2.3 Software update	14
2.4 Service	15
2.5 User interface settings	15
2.5.1 Language selection	16
2.5.2 Selecting the startup screen	16
2.5.3 Changing the date and time	17
2.6 Information about the Meter	17
2.7 Factory (default) settings	18
3 Measurements	19
4 Memory	22
4.1 Memory management (clients, objects, measuring points)	22
4.1.1 Entering the clients	22
4.1.2 Entering objects, subobjects, measurement points	23
4.1.2.1 Entering objects and subobjects	23
4.1.2.2 Entering measurement points	26
4.2 Storing the measurement results in the memory	28
4.2.1 Entering the results of measurements with previously organized memory	28
4.2.2 Entering the results of measurements without previously organized memory	29
4.2.2.1 Method 1	29
4.2.2.2 Method 2	31
4.3 Viewing memory data	32
4.4 "Search" in the memory	33
4.5 Copying client data from the memory to USB stick and vice versa	35
4.6 Deleting data	36
4.6.1 Deleting the meter's memory data	36
4.6.2 Deleting a client	36
4.6.3 Deleting an object	37
5 Power supply	38
5.1 Monitoring the power supply voltage	38
5.2 Replacing the battery pack	38
5.3 General rules for using Li-Ion rechargeable batteries	39
6 Cleaning and maintenance	39
7 Storage	40

8 Dismantling and Disposal	40
9 Technical specifications	40
10 Accessories	41
10.1 Standard accessories.....	41
10.2 Optional accessories.....	42
11 Manufacturer	42
12 Laboratory services	43

1 Safety

MMR-640 is a meter designed for measuring resistance of various types of connections (welded, soldered, butt). It is used to obtain results that determine safety condition of electrical installations. Therefore, in order to provide conditions for correct operation and accuracy of obtained results, the following recommendations must be observed:

- Before you proceed to operate the meter, acquaint yourself thoroughly with the present manual and observe the safety regulations and specifications provided by the producer.
- MMR-640 meter is designed to measure low-resistance values. Any application that differs from those specified in the present manual may result in a damage to the device and constitute a source of danger for the user.
- In case of measurements on systems, components and devices that may be under dangerous voltage, MMR-640 may be used only by qualified persons who are authorized to work on electric installations. Unauthorized use of the meter may result in its damage and may be a source of serious hazard to the user.
- Using this manual does not exclude the need to comply with occupational health and safety regulations and with other relevant fire regulations required during the performance of a particular type of work. Before starting the work in special environments – e.g. potentially fire-risk/explosive environment – it is necessary to consult it with the person responsible for health and safety.
- It is unacceptable to operate the device when:
 - ⇒ a damaged meter which is completely or partially out of order,
 - ⇒ a meter with damaged insulation,
 - ⇒ a meter stored for an excessive period of time in disadvantageous conditions (e.g. excessive humidity). **If the meter has been transferred from a cool to a warm environment with a high level of relative humidity, do not start measurements until the meter is warmed up to the ambient temperature (approximately 30 minutes).**
- Before measurement make sure that test leads are connected to appropriate measuring terminals.
- Do not operate a meter with an open or incorrectly closed battery compartment and do not power it from other sources than those specified in this manual.
- The inputs of the meter are protected electronically against overload e.g. due to having been connected to a live circuit: for all combinations of inputs - up to 600 V for 10 seconds.
- Repairs may be performed only by an authorised service point.
- The device meets the requirements of EN 61010-1, EN 61010-2-030 and EN 61010-031.



- The manufacturer reserves the right to introduce changes in appearance, equipment and technical data of the meter.
- An attempt to install drivers in 64-bit Windows 8 and Windows 10 may result in displaying "Installation failed" message.
Cause: Windows 8 and Windows 10 by default block drivers without a digital signature.
Solution: Disable the driver signature enforcement in Windows.

2 General Settings - menu

When the meter is turned on, it displays the main menu.

Indication of overheating of the power supply adapter, battery or measuring current controller and no battery indication

Full memory indicator

Power supply from mains



Battery charge level, x – indicates empty battery or no battery in the compartment

2.1 Meter Settings

① In the main menu, select icon .



Select **Meter settings**.

2.1.1 Energy saving

In order to save its rechargeable battery, the meter automatically shuts off or blanks the screen after an adjustable inactivity period.

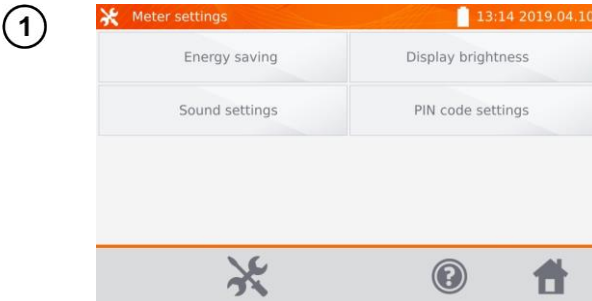

Select **Energy saving**.

2

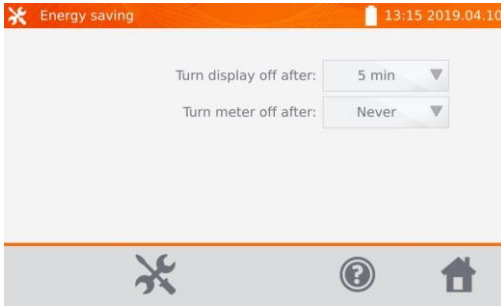

Set the inactivity time for blanking the screen and turning the meter off.

2.1.2 Sound settings

1

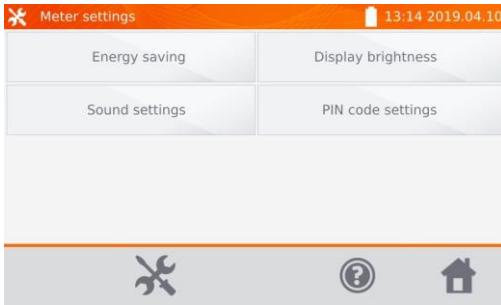

Select **Sound settings**.

2

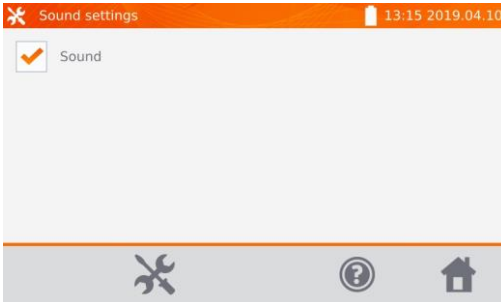

Select the box to turn on () or off the sound signals.

2.1.3 PIN code settings

The PIN code is used for connecting the meter to the computer.

①

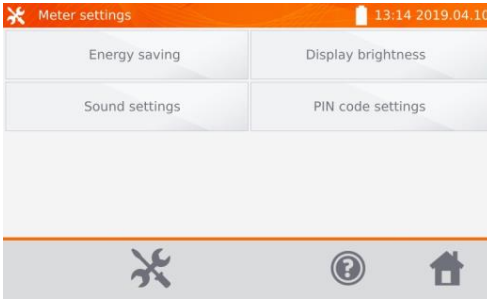

Select **PIN code settings**.

②

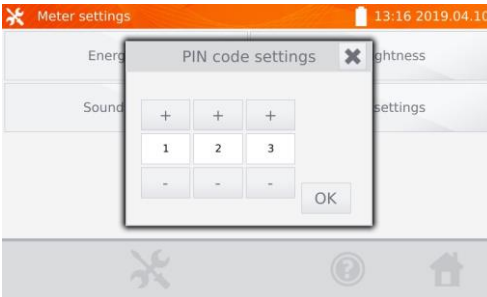

Use **+** and **-** icons to set the code and confirm it by pressing **OK**.

The PIN code is used for communication with PC. The default code is **123**.

2.1.4 Display brightness settings

①

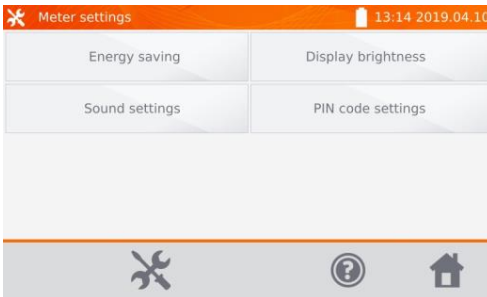

Select **Display brightness**.

②

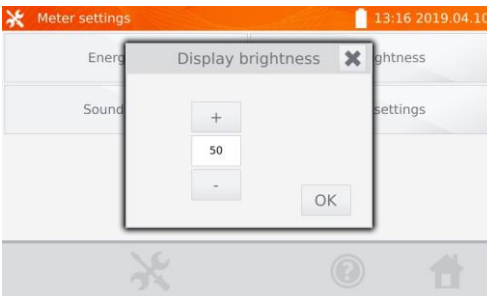

Use **+** and **-** icons to set the desired brightness. Confirm it by pressing **OK**.

2.2 Memory settings

- 1 In the main menu, select  icon.



By pressing , you may enter settings or enter the higher level in the settings.

2

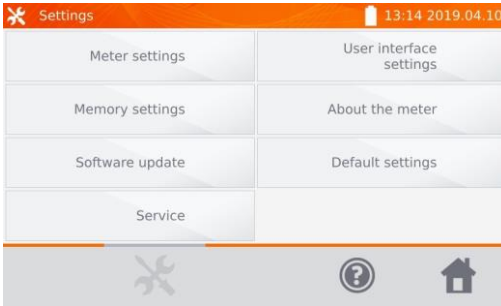

Select **Memory settings**.

2.2.1 Memory management

1

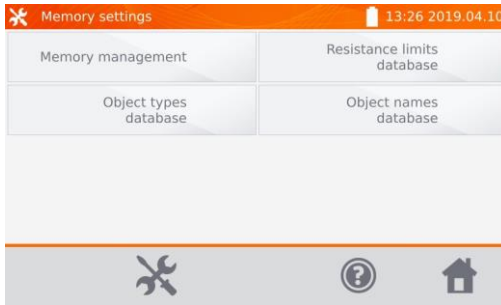

Select **Memory management**.

2



Except reading the % of the used memory, this option allows to clear it. After pressing **Delete memory** all clients are deleted with their objects and measurement results.

Use  icon located at the client to delete individual client.

Use icons  /  to switch between USB memory and meter memory.

Use icon  to initiate the process of copying clients to the USB memory and vice versa.

2.2.2 Object types database

This is a list of types of tested objects.

1

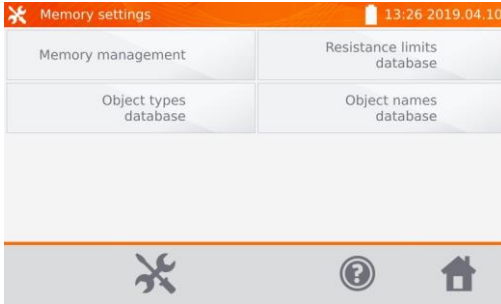

Select **Object types database**.

2

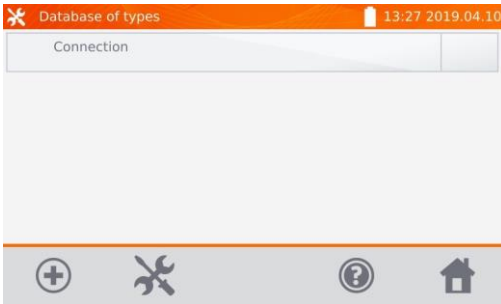

The meter has default types saved in its memory. Use **+** icon to add a new type of the tested object.

3



Enter a new type of the object being tested.

4

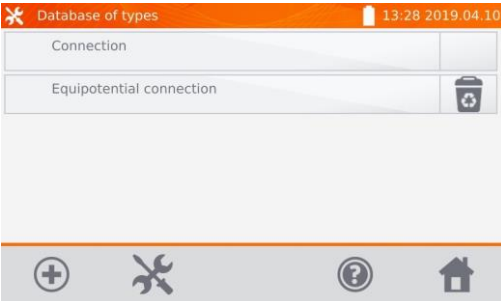

Added types may be deleted by pressing **🗑**.

2.2.3 Object names database

It is a list of names of tested objects or measurement points.

1

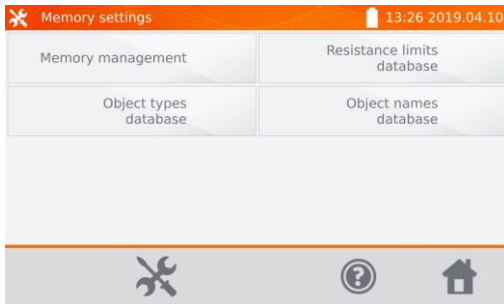

Select **Object names database**.

2



The meter has 4 default names saved in its memory. Use **+** icon to add a new name.

3



Enter the name of the object.

4



Added names may be deleted by pressing **🗑**.

2.2.4 Resistance limits database

The specified limits may be used to automatically assess the validity of the results of resistance measurements.

1

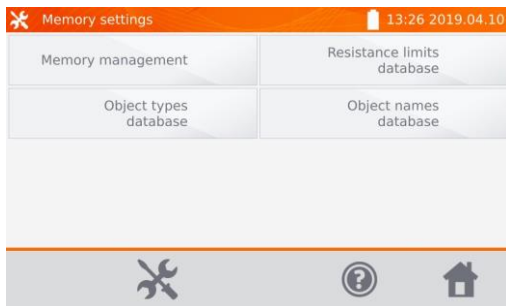

Select **Resistance limits database**.

2

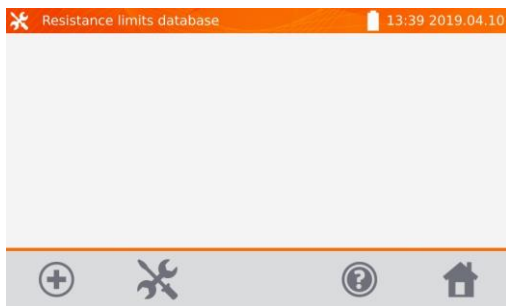

Select **+** to add a new limit.

3

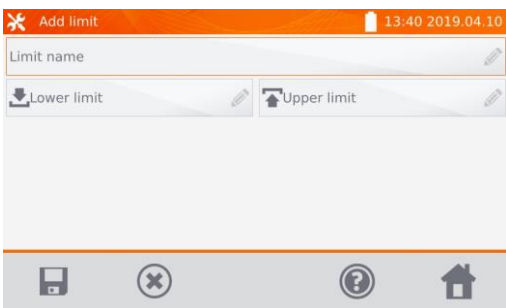

Tap **Limit name** box.

4



Enter the name of the limit.
Use **▶** icon to go to the lower limit setting.

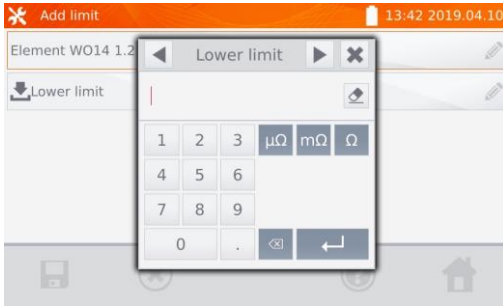

5

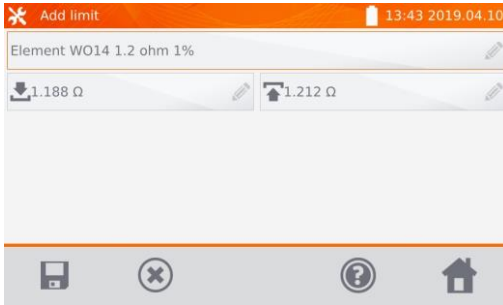

Enter the lower limit. Use  to go to the upper limit setting. You can set only one of the limits.

6



Use  to save the limit in the memory. By pressing  you may exit without saving.

7

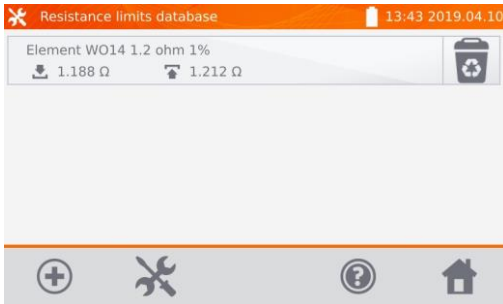

Use  to delete the limit.

2.3 Software update

The software of the meter is periodically modified. You may download its current version from www.sonel.pl.

① In the main menu, select icon .



Select **Software update**.

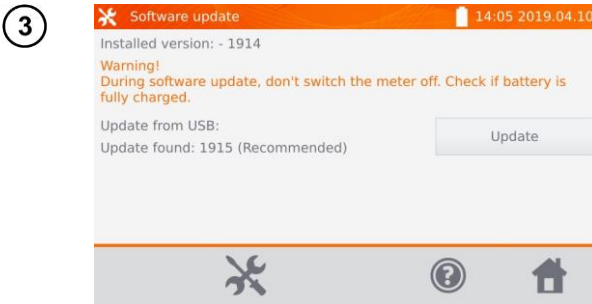

Read the displayed text. To perform an update insert the USB drive with the update files and select **Update** button.

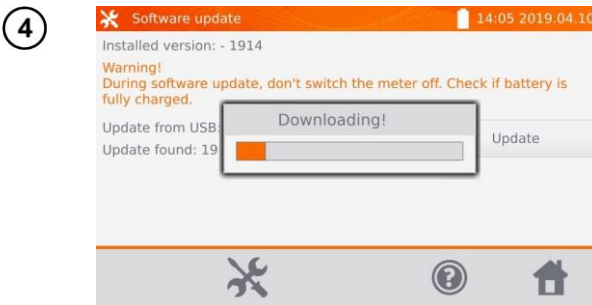

The meter is downloading software.

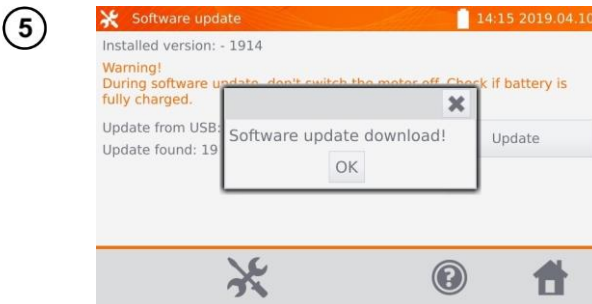

Select **OK** to run the update or close the window to cancel.



NOTE!

Update is performed automatically and may be divided into a few stages. During the update, do not turn off the power supply of the meter and do not remove the USB drive. The update process is continued until the meter displays the main menu screen.

6



Only at this point, you can turn off the power supply of the meter or start its use.

2.4 Service

This function is available for factory servicing and is protected by password.

2.5 User interface settings

1

In the main menu, select icon .

2

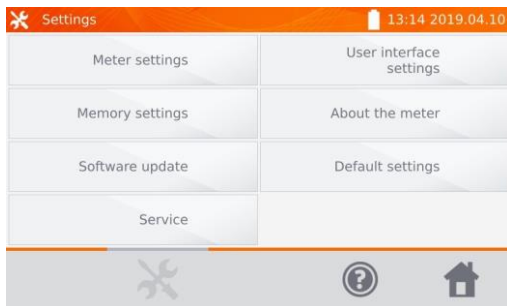

Select **User interface settings**.

2.5.1 Language selection

①

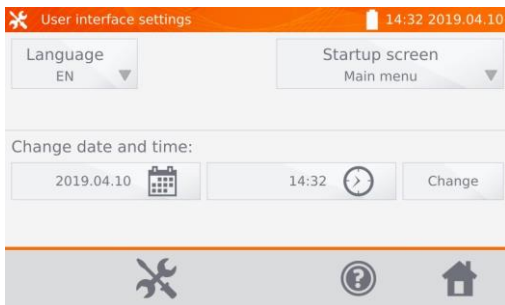

Select **Language** button.

②

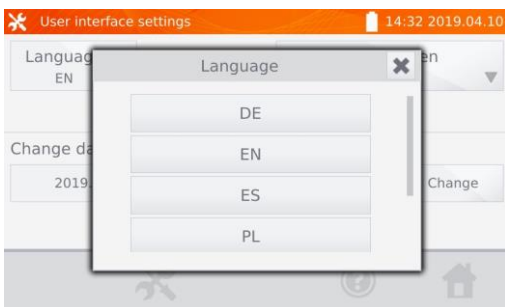

Select the language.

2.5.2 Selecting the startup screen

①

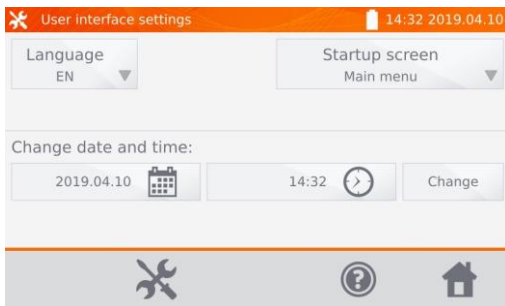

Select **Startup screen** button.

②

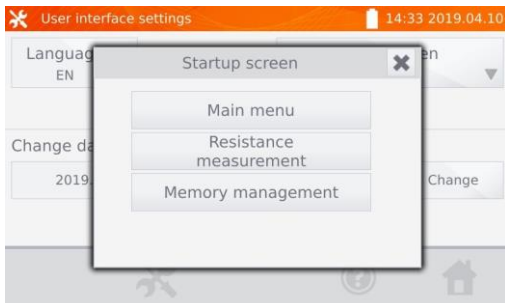

Select the desired startup screen. The screen will be automatically shown after turning the meter on.

2.5.3 Changing the date and time

1

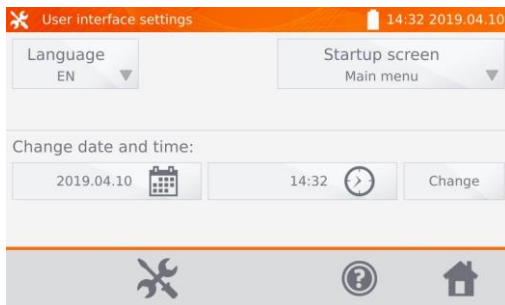

Select date icon.

2

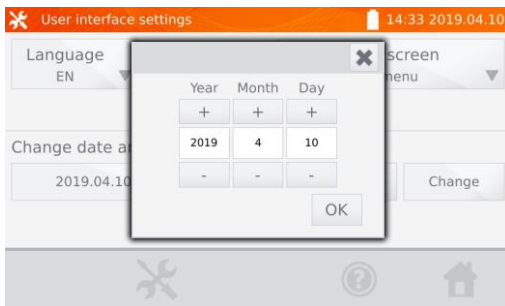

Use **+** and **-** icons to set year, month and day, then and confirm it by pressing **OK**. Similarly, you may set the time. To make changes, select **Change** button.

2.6 Information about the Meter

1

In the main menu, select icon .

2

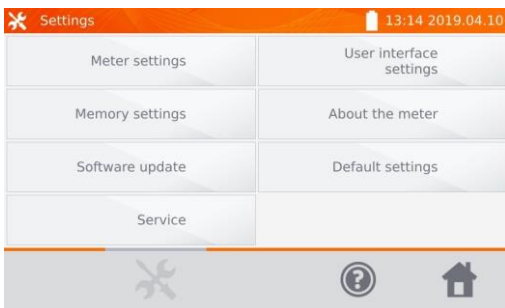

Select **About the meter**.

3



The screen will display information on the meter and its manufacturer.

2.7 Factory (default) settings

① In the main menu, select icon .



Select **Default settings**.



Select **Restore default settings** to reset the meter. Select  icon to cancel and return to the menu.

The following elements are restored to the default settings:

- measurement settings,
- list of object types,
- list of object names,
- list of R limits,
- list of T limit, sound settings,
- default startup screen,
- PIN code settings,
- energy saving settings,
- display brightness.

3 Measurements



- If the current test leads are not connected, a message appears: **Lack of continuity of current leads.**
- If the voltage test leads are not connected, a message appears: **Lack of continuity of voltage leads.**

1

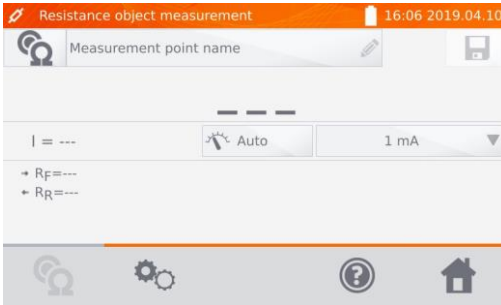

Measurement screen.

2

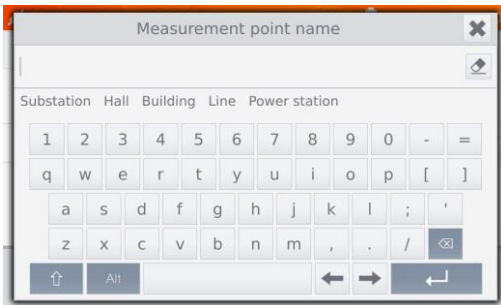

When necessary, enter the name of the measurement point.



- After entering the name of the measuring point, the measurement result will be saved in the memory - after selecting the client and object (subobject) you may simply select  icon to create and save the point automatically.
- If another point already existing in the memory is selected when saving, the name will be overwritten.

3

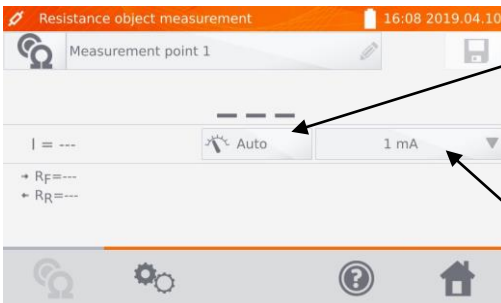

Auto/Manual switching (auto / manual range selection):

Auto - the measuring current is limited to a value not exceeding the set value,
Manual - measuring current has the set value.

Setting the measuring current.

4 Use  icon to go to measurement settings.

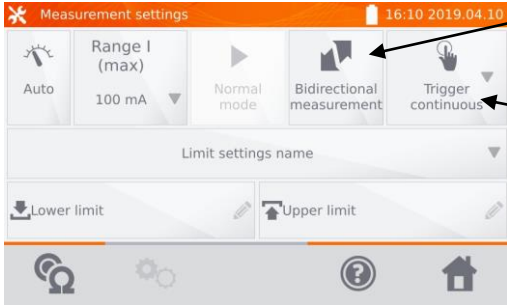

Switching measurement:

- unidirectional,
- bidirectional.

Selecting trigger method:

- ⇒ manual: use **START/STOP** button
- ⇒ automatic: by connecting test leads to the object,
- ⇒ continuous: after pressing **START/STOP** button, the meter measures the resistance in a continuous way to the moment, when the test is terminated by pressing **START/STOP** button.

Boxes for setting the range and measurement current correspond to the same boxes shown in step 3.



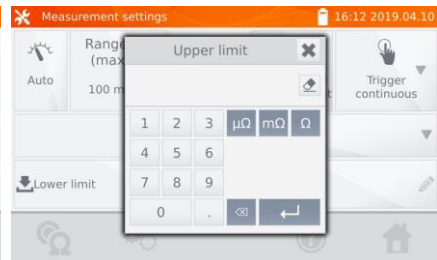
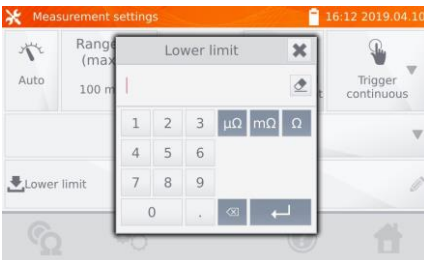
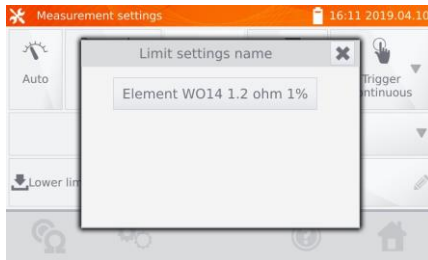

- Bidirectional measurement is used to compensate the potential present at the contact point of two different conductors. In this case, the main result of the measurement is the average of results from individual directions.
- After selecting automatic trigger, the first measurement must be started by pressing **START/STOP** button. Next measurements may be initiated by connecting the test leads to the object.
- Automatic trigger operates correctly for resistance ≤ 4 k Ω . Above this value there is no guarantee of correct operation.

5 If necessary, select resistance limits from the database (**Limit settings name**) or set the required limits for the performed measurement by clicking **Lower limit** and/or **Upper limit**. To deactivate the limit delete the lower and upper values.

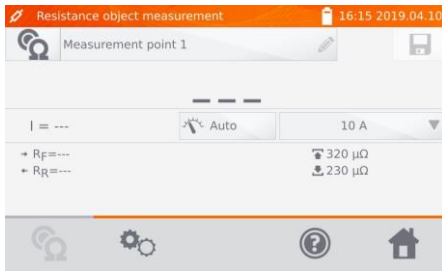

6



Press  icon to go to the measurement.

7

Connect the meter to the tested object. Press **START/STOP** button.

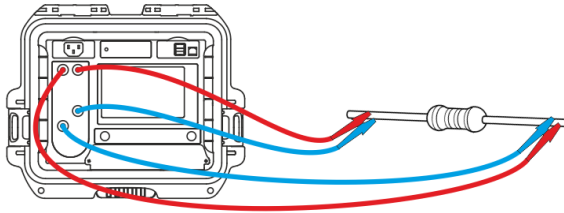

NOTE!

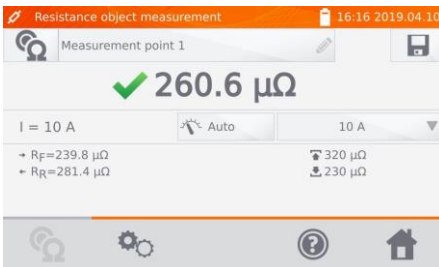

Touch the surface with the double-pin Kelvin probe held perpendicularly to the surface, as any other position may damage the probe.



Correct result: R_0 within limits.



Incorrect result" R_0 outside limits.

- R_F – resistance at the measuring current flowing in the assumed positive direction
- R_R – resistance at the measuring current flowing in the assumed negative direction
-  – upper limit
-  – lower limit



- The measuring current is obtained from a current source.
- The result may be entered into the memory by pressing  icon (see **sec. 4.2**).

4 Memory

4.1 Memory management (clients, objects, measuring points)



- The memory may be organized before the measurements, or on a regular basis, after the measurement.
- Use  icon to enter the memory management for measurements results, as well as to enter a higher level in the memory.

4.1.1 Entering the clients

1



Select **Memory management** to enter the memory.

2

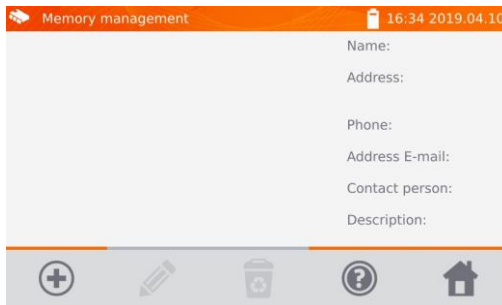

Select  to add a client.

3

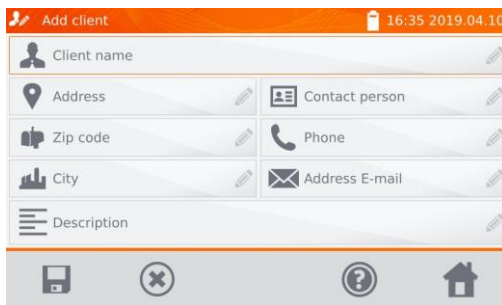

By selecting the individual fields, enter customer data using the keyboard.

Client name (box marked in orange) is mandatory.

4

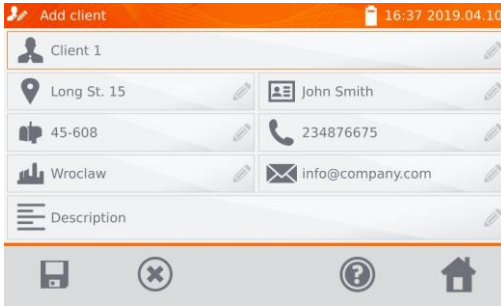

Use  icon to save client's data in the memory.

5

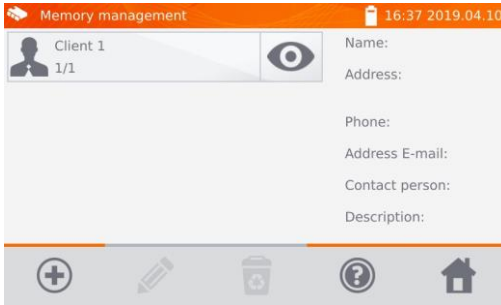

4.1.2 Entering objects, subobjects, measurement points

4.1.2.1 Entering objects and subobjects

1

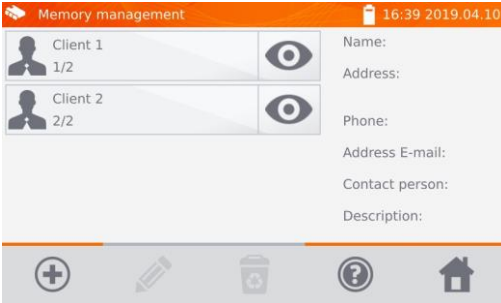

Select  associated with the selected client.

2

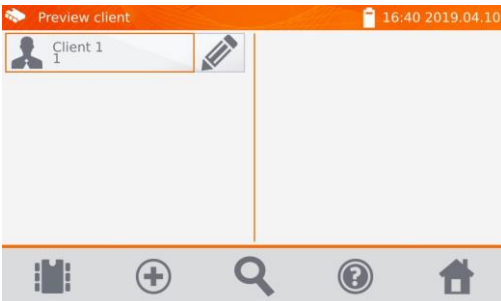

To add an object or measuring point select .

3

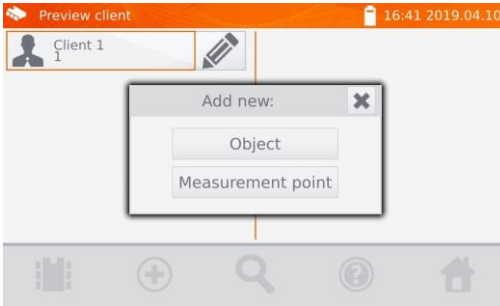

Select **Object** button.

4

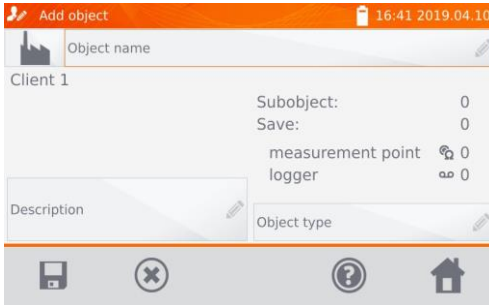

Select **Object name** box to name the object (mandatory).

5



Select one of the default names or enter your own.

6

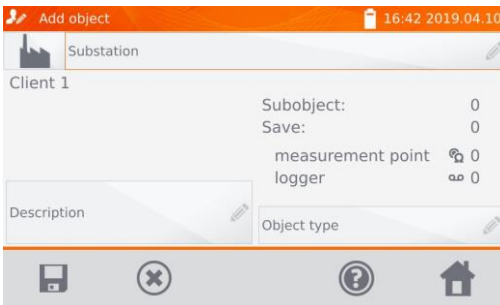

In the box **Description** you may attach an additional description. In the box **Object type** box you may select the default type of or enter your own.

7



Select one of the default names or enter your own.

8

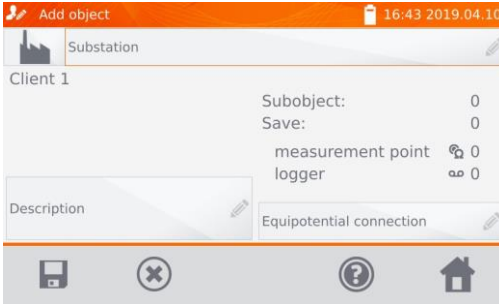

Use  icon to save the object into the memory.

9

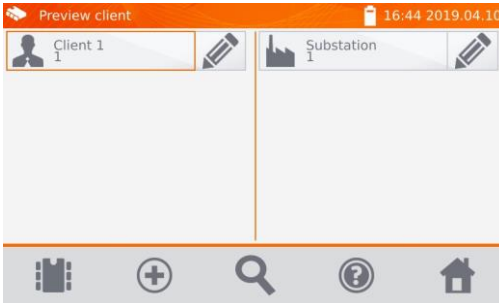

By clicking  you can add more objects.

By clicking the **object** field and  icon, you may enter subsubjects in the object etc. - up to 4 levels.

10

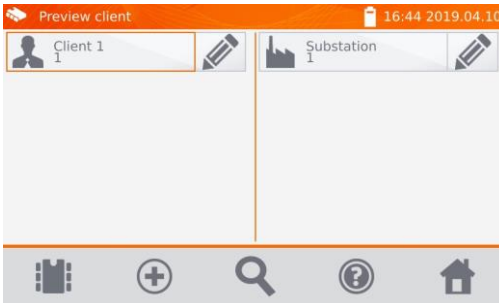

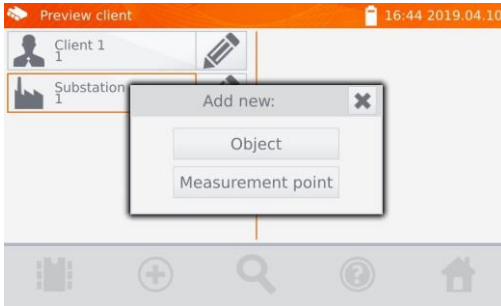

4.1.2.2 Entering measurement points

Measuring points may be entered at any memory level, i.e. at the level of client, object or subobject.

①

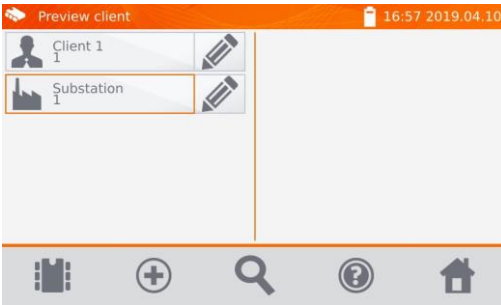

Select

⇒ associated with the client, and then

or

⇒ at the level of the object (subobject) press .

②

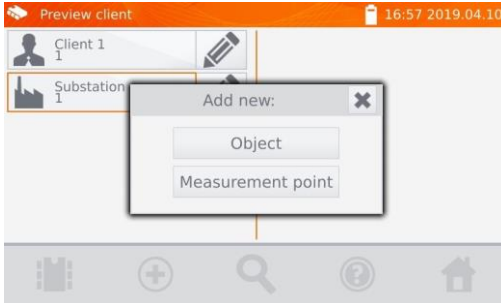

Select **Measurement point**.

③

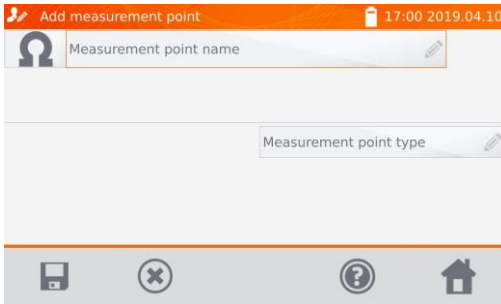

Select **Measurement point name** box to name the object (mandatory).

4



Select one of the default names or enter your own.

5

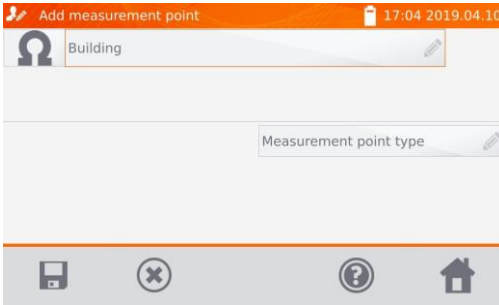

By clicking **Measurement point type** box, you may select the default type of or enter your own.

6

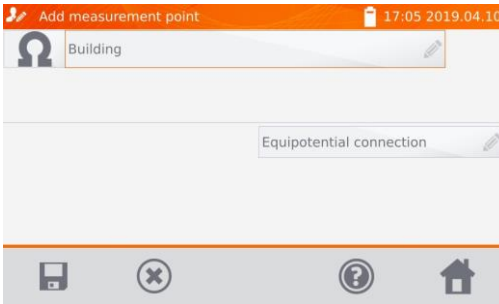

Use  icon to save a measuring point to the memory.

7

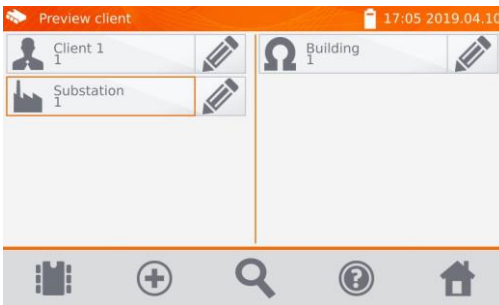

4.2 Storing the measurement results in the memory



NOTE!

- Before performing the next series of measurements at the same measuring points, the previous results must be archived, because **for one measuring point, you can save only one result**. Entering the next will erase the previous one.
- The measurement result may be entered only to the measuring point or to logger.

4.2.1 Entering the results of measurements with previously organized memory

①

Tap  icon after finishing the measurement.

②

Select the client by tapping  icon next to its name.

③

Select the object/subobject.

4

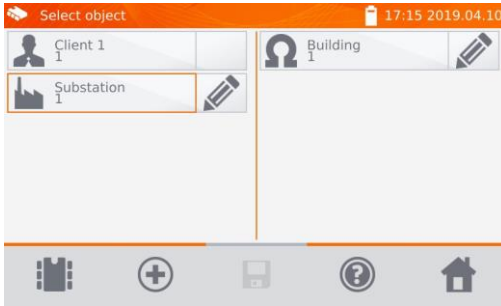

Select the measuring point (indicated by orange border).

5

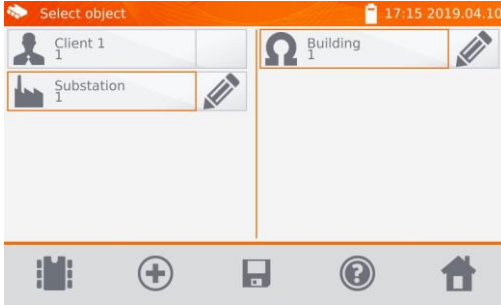

Save the result by selecting  icon.

4.2.2 Entering the results of measurements without previously organized memory

4.2.2.1 Method 1

1



Tap  icon after finishing the measurement.

2

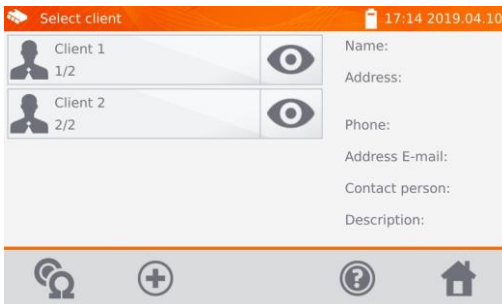

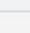

Select  icon to add a client.

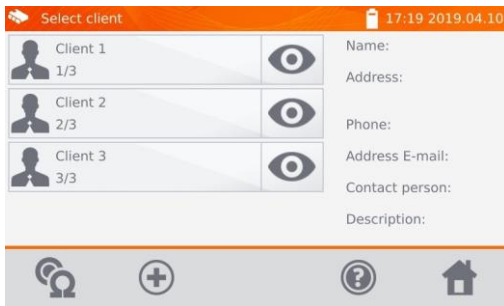
3



After saving the client:

- select its icon 
- and then select  icon to add the object.

4

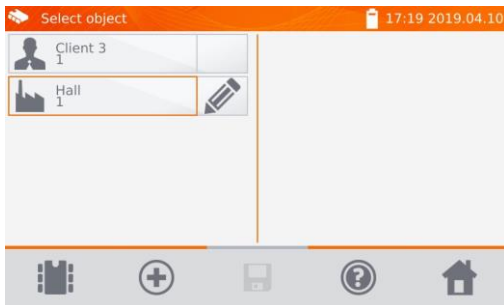

After adding and saving the object (also subobjects if necessary), select  to add the measurement point.

5

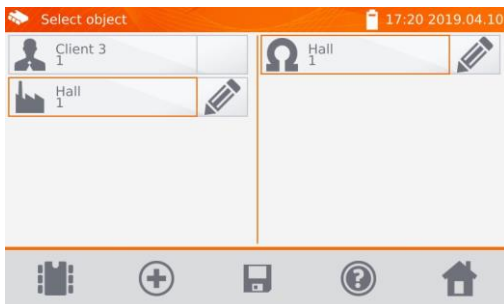

After adding and saving the measuring point, select . The result is saved to memory. The meter returns to the measuring mode.

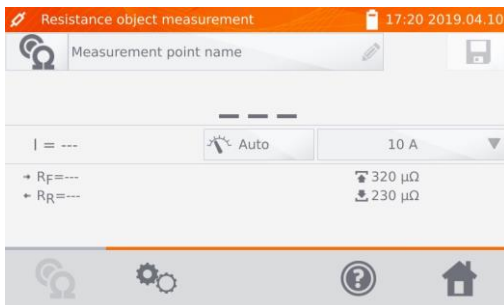

4.2.2.2 Method 2

①

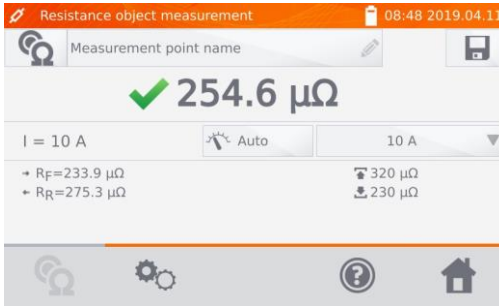

Before or after the measurement select **Measurement points name** and enter the name.

②

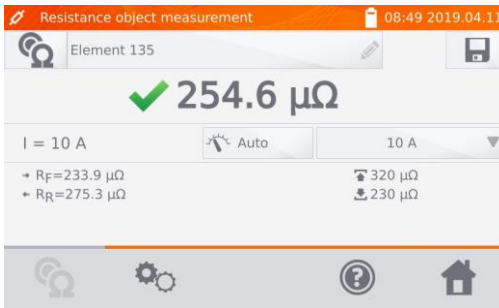

After finishing the measurement press  icon.

③

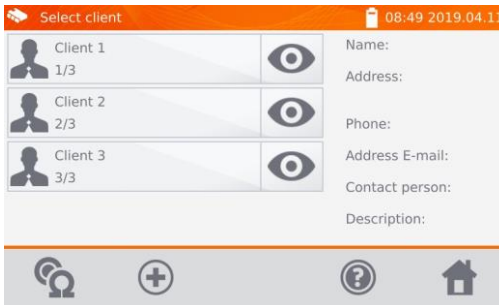



Select  to add a client.

④



After saving the client:

- select icon  next to its name
- and then select  icon to add the object.

5

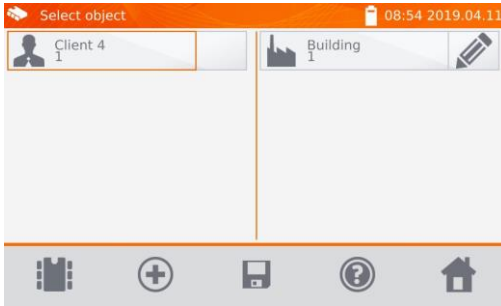

After adding and saving the object (also subobjects according to the needs), select the object and then . The measuring point with the measurement result will be saved automatically.



Having selected the client and object (subobjects) and performing a series of measurements on one object, after the measurement and entering the name of the measuring point, select and - on the displayed screen - select again . The measuring point with the measurement result will be saved automatically.

4.3 Viewing memory data

1

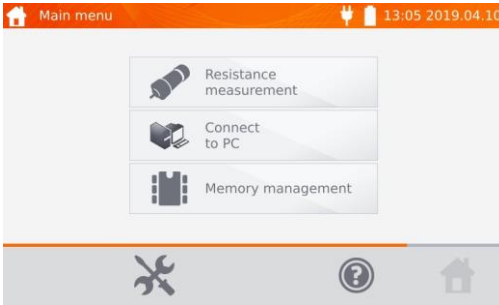

Select **Memory management**.

2

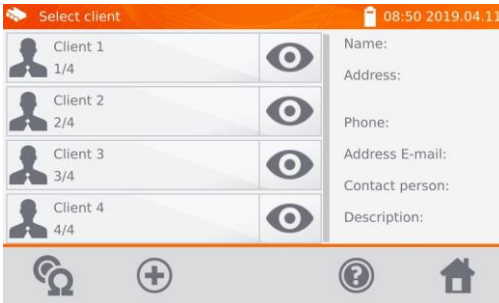

Select of the selected object and then select on the object, subobjects and measuring point.

3



4.4 "Search" in the memory

1



Select **Memory management**.

2



Select  of the desired client.

3

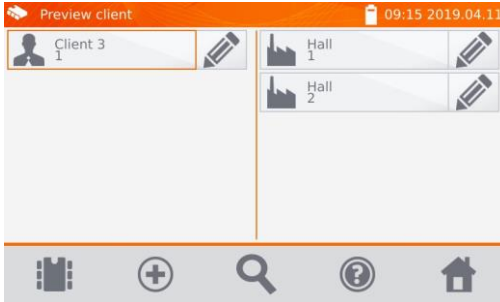

In any of the client's window, select  icon.

4

Mark appropriate positions

Enter the object type or select the default type

Enter the relevant dates

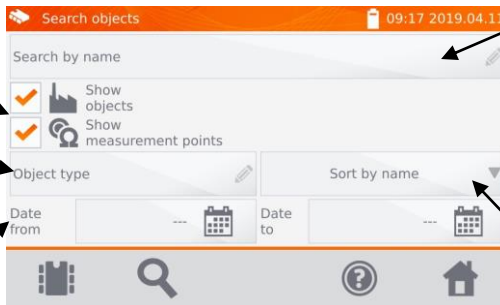

Enter the name or its several subsequent letters.

Selecting sorting by name or date

5

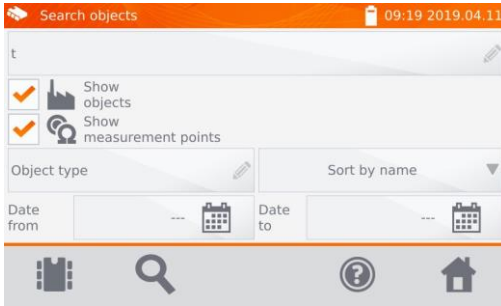

After entering all the search criteria, select  icon again.

6

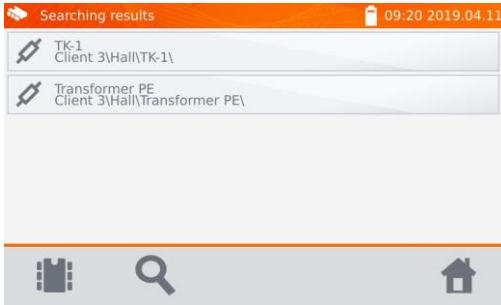

Search results.



- To perform the search, enter the name (or its part) or one of the dates.
- The size of letters in the name of searched item is ignored.

4.5 Copying client data from the memory to USB stick and vice versa

1

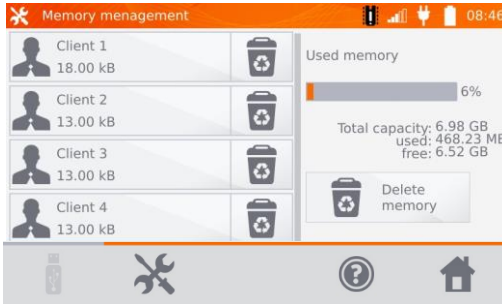

In the main menu, select , then **Memory settings** and **Memory management**.

2

Insert the USB stick into the appropriate USB slot of the meter.

3



Select  icon.

4

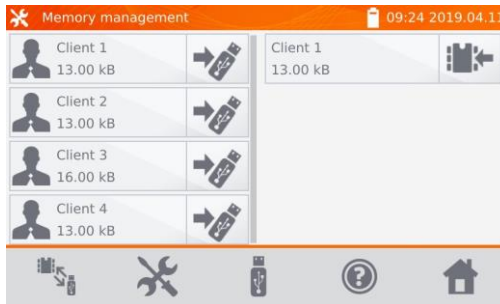

⇒ Select  to save data in the USB stick.

⇒ Select  to copy data from the USB stick to the memory of the meter.

4.6 Deleting data

4.6.1 Deleting the meter's memory data

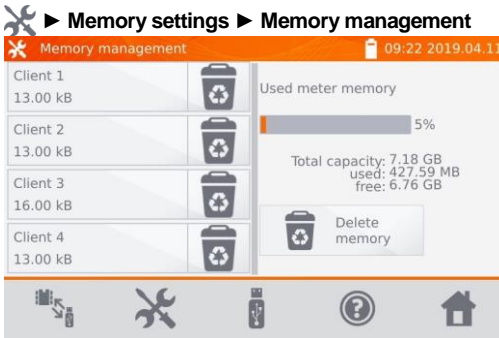

To delete the whole memory, select **Delete memory** button.



4.6.2 Deleting a client

①

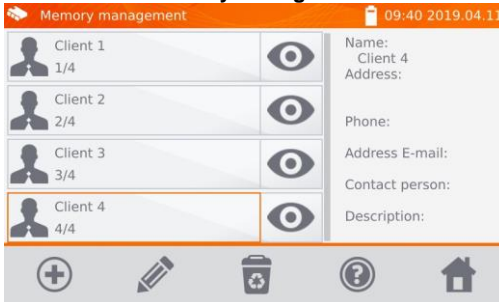
Main menu ► Memory management



To delete a client:

- ⇒ in **location 1** select a client and then  icon at the bottom bar,
- ⇒ in **location 2** select  icon associated with its name.

or

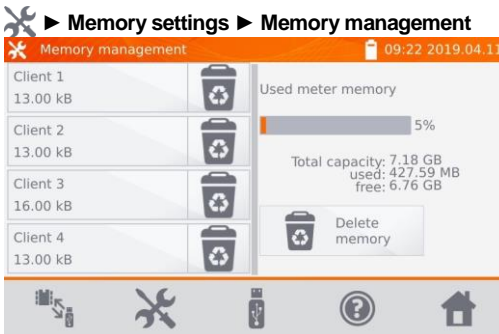

2

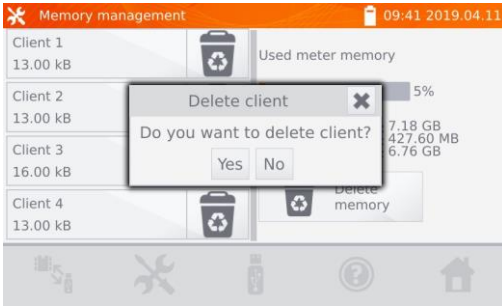



Select **Yes** to confirm deleting or **No** to cancel it.

4.6.3 Deleting an object

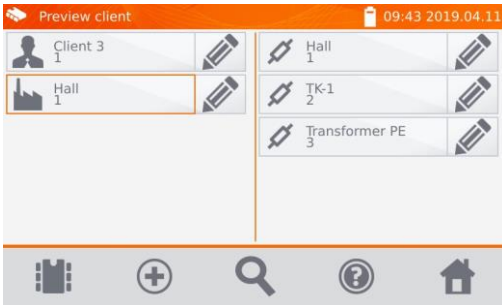
1



To delete an object or measuring point:

- go to location **Main menu** ► **Memory management**
- using  icon go to the client's content,
- using  icon start to edit the selected object...

2

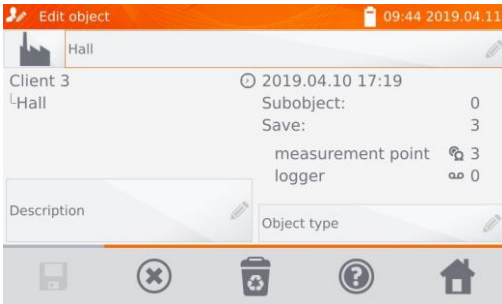

...and then select .

3

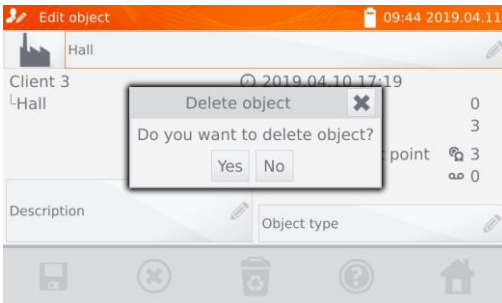

Select **Yes** to confirm deleting or **No** to cancel it.

5 Power supply

The meter is powered by an AC adapter or a battery pack. When supplied from the mains, the battery pack is charged.

5.1 Monitoring the power supply voltage

The charge level of the battery pack is indicated by the symbol in the right upper corner of the display on a current basis:



the battery pack is charged



the battery pack is discharged



the battery pack is being charged



NOTE!

Remember that measurements performed with an insufficient supply voltage feature additional errors which the user is unable to evaluate. Consequently, such measurements cannot prove that the results of resistance measurements are correct.

5.2 Replacing the battery pack

MMR-640 is equipped with a rechargeable lithium-ion battery pack and a charger. The battery pack is placed in the battery compartment. Battery charger is installed inside the housing of the meter and is compatible only with the manufacturer's rechargeable battery pack.



WARNING

If the power cord is left in the socket during replacement of the battery pack, there is a risk of electric shock with a dangerous voltage.

In order to replace the batter-pack it is necessary to:

- remove all the test leads from the sockets and turn the meter off,
- remove the lid of the battery compartment (in the upper part of the housing) by removing 2 screws,
- remove the battery pack,
- remove two connector pins of the battery pack,
- connect the power plugs of the new battery pack,
- insert the battery pack into the battery compartment,
- place and tighten the lid of battery compartment.



NOTE!

Do not operate a meter with an open or incorrectly closed battery compartment and do not power it from other sources than those specified in this manual.

5.3 General rules for using Li-Ion rechargeable batteries

- If you do not use the device for a prolonged period of time, then it is recommended to remove the rechargeable batteries and store them separately.
- Store the half-charged battery pack in a plastic container placed in a dry, cool and well ventilated place and protect them from direct sunlight. The battery pack may be damaged if stored when fully discharged. The ambient temperature for prolonged storage should be maintained within the range of 5°C...25°C.
- Charge the batteries in a cool, well-ventilated place at a temperature of 10°C ... 28°C. Modern fast chargers detect both too low and too high temperature of rechargeable batteries and react to the situation adequately. Too low temperature should prevent starting the process of charging, which might irreparably damage rechargeable batteries. The increase in temperature of the battery pack may cause electrolyte leakage and even its ignition or explosion.
- Do not exceed the charging current, as it may result in ignition or "swelling" of the battery pack. "Swollen" battery pack must not be used.
- Do not charge or use the batteries in extreme temperatures. Extreme temperatures reduce the lifetime of rechargeable batteries. Always observe the rated operating temperature. Do not dispose the battery pack into fire.
- Li-Ion cells are sensitive to mechanical damage. That may cause its permanent damage of the batteries and thus - ignition or explosion. Any interference in the structure of Li-ion battery pack may cause its damage. This may result in the ignition or explosion. A short-circuit of the battery poles + and - may permanently damage the battery pack or even cause its fire or explosion.
- Do not immerse Li-Ion battery in liquids and do not store in humid conditions.
- If the electrolyte contained in the Lithium-Ion battery pack, contacts eyes or skin, immediately rinse the affected place with plenty of water and consult a doctor. Protect the battery against unauthorised persons and children.
- When you notice any changes in the Lithium-Ion battery pack (e.g. changes in colour, swelling, excessive temperature), stop using it. Mechanical damaged, overcharged or excessively discharged battery pack is not suitable for use.
- Any misuse of the battery may cause its permanent damage. This may result in the ignition. The seller and the manufacturer shall not be liable for any damages resulting from improper handling Li-Ion battery pack.

6 Cleaning and maintenance



NOTE!

Use only the maintenance methods specified by the manufacturer in this manual.

The casing of the meter may be cleaned with a soft, damp cloth using all-purpose detergents. Do not use any solvents or cleaning agents which may scratch the casing (powders, pastes, etc.).

The electronic system of the meter does not require maintenance.

7 Storage

In the case of storage of the device, the following recommendations must be observed:

- disconnect all the test leads from the meter.
- make sure that the meter and accessories are dry,
- during prolonged storage remove the batteries,
- storage temperatures must be in accordance with those defined in technical specifications,
- in order to prevent total discharge of the rechargeable batteries during prolonged storage, charge them from time to time.

8 Dismantling and Disposal

Worn-out electric and electronic equipment should be gathered selectively, i.e. it must not be placed with waste of another kind.

Worn-out electronic equipment should be sent to a collection point in accordance with the law of waste electrical and electronic equipment.

Before the equipment is sent to a collection point, do not dismantle any elements.

Observe the local regulations concerning disposal of packages, worn-out batteries and accumulators.

9 Technical specifications

⇒ Abbreviation "m.v." used in the specification of measurement uncertainty means a standard measured value.

Uncertainty values stated in the table refer to the measurement with bidirectional current and relate to the average of two measurements according to the following formula:

$$R = \frac{R_F + R_R}{2}$$

where:

R_F – resistance at the assumed "forward" current direction,



R_R – resistance at the assumed "backward" current direction.

For measuring with unidirectional current, the specified accuracy is not guaranteed.

Resistance measurements of resistive objects

Range	Resolution	Basic uncertainty *	Measuring current
0...999.9 $\mu\Omega$	0.1 $\mu\Omega$	$\pm(0.25\% \text{ m.v.} + 2 \text{ digits})$	10 A
1.0000...1.9999 m Ω	0.0001 m Ω		10 A
2.000...19.999 m Ω	0.001 m Ω		10 A / 1 A
20.00...199.99 m Ω	0.01 m Ω		1 A / 0.1 A
200.0...999.9 m Ω	0.1 m Ω		
1.0000...1.9999 Ω	0.0001 Ω		
2.000...19.999 Ω	0.001 Ω		0,1 A
20.00...199.99 Ω	0.01 Ω		10 mA
200.0...1999.9 Ω	0.1 Ω		1 mA

Resistance measurement in the presence of noise of 50 Hz or 60 Hz

Signal/noise ratio	Additional uncertainty	Signalling
$N \geq 0.02$	-	-
$0.02 > N \geq 0.004$	1%	
$N < 0.004$	unspecified	 + 

Other technical specifications:

- a) insulation type double, according to EN 61010-1
b) measurement category III 600 V acc. to EN 61010-2-030



NOTE!

With the use of 10 m or 25 m measurement leads with a crocodile - CAT III 50 V.

- c) ingress protection acc. to EN 60529
▪ with closed housing IP67
▪ with open housing, powered from the battery pack, installed plugs IP54
▪ with open housing, powered from mains and/or without plugs IP40
- d) protection against external voltage up to 600 V AC for 10 s
- e) power supply Li-Ion rechargeable battery 7.2 V 8.8 Ah
- f) power supply to battery charger 90 V...265 V, 50 Hz...60 Hz, 2 A
- g) battery charging time approximately 3.5 hours
- h) number of measurements with 10 A current when powered from the battery pack
.....700...800, depending on the ambient temp.
- i) maximum wire resistance for 10 A current 300 mΩ
- j) accuracy of measuring current setting ±10%
- k) time of performing the resistance measurement with bidirectional current flow 3 s
- l) dimensions 318 x 257 x 152 mm
- m) meter weight approx. 3.5 kg
- n) operating temperature -10°C...+50°C
- o) charger operating temperature 0°C...+45°C
- p) storage temperature -20°C...+60°C
- q) humidity 20%...90%
- r) reference temperature +23°C ± 2°C
- s) reference humidity 40%...60%
- t) altitude (above sea level): <2000 m
- u) time to AUTO-OFF 5...45 minutes or inactive
- v) TFT graphic display graphical TFT, 800 x 480 points
- w) interface standard USB
- x) quality standard design and manufacturing are ISO 9001 compliant
- y) the product meets the EMC requirements (emission for industrial environment) according to:
..... EN 61326-1 and EN 61326-2-2

10 Accessories

The current list of accessories can be found on the manufacturer's website.

10.1 Standard accessories

The standard set of equipment supplied by the manufacturer includes:

- MMR-640 meter – **WMGBMMR640**,
- 3 m double-wire cable U111 – **WAPRZ003DZBBU111**,
- 3 m double-wire cable U212 – **WAPRZ003DZBBU212**,
- Kelvin crocodile (2 pcs) – **WAKROKELK06**,
- power cord – **WAPRZ1X8BLIEC**,
- meter case and accessories L11 – **WAFUTL11**,
- USB cable – **WAPRZUSB**,
- Li-Ion 7.2 V rechargeable battery – **WAAKU27**,
- user manual,
- calibration certificate issued by an accredited laboratory
- guarantee card.

10.2 Optional accessories

Additionally, the following items that are not included in the scope of standard equipment can be purchased from the manufacturer or the distributors:

WAPRZ010DZBBU11
WAPRZ015DZBBU11

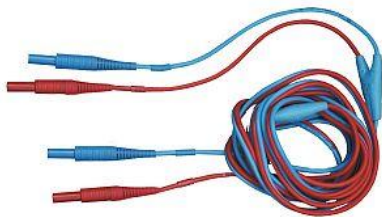

- test lead CAT III/1000 V CAT IV/600 V double-wire (16 / 32 A) U1/I1, 10 m / 15 m

WAPRZ010DZBBU212
WAPRZ015DZBBU212

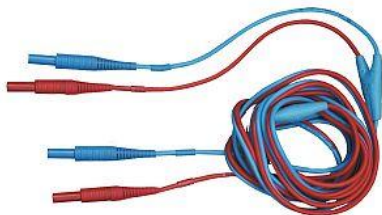

- test lead CAT III/1000 V CAT IV/600 V double-wire (16 / 32 A) U2/I2, 10 m / 15 m

WAZACKEL1



- Kelvin clamp with a 2.6 m double-wire cable

WASONKEL20GB



- double pin Kelvin probe with banana connectors

11 Manufacturer

The manufacturer of the device and provider of guarantee and post-guarantee service:

SONEL S.A.

Wokulskiego 11
58-100 Świdnica
Poland

tel. +48 74 858 38 60

fax +48 74 858 38 09

E-mail: export@sonel.pl

Web page: www.sonel.pl



NOTE!

Service repairs must be performed only by the manufacturer.

12 Laboratory services

SONEL Testing and Calibration Laboratory has been accredited by the Polish Center for Accreditation (PCA) - certificate no. AP 173.

Laboratory offers calibration for the following instruments that are used for measuring electrical and non-electrical parameters.



AP 173

● METERS FOR MEASUREMENTS OF ELECTRICAL PARAMETERS

- voltage meters,
- current meters (including clamp meters),
- resistance meters,
- insulation resistance meters,
- earth resistance and resistivity meters,
- RCD meters,
- short-circuit loop impedance meters,
- power quality analyzers,
- portable appliance testers (PAT),
- power meters,
- multimeters,
- multifunction meters covering the functions of the above-mentioned instruments,

● ELECTRICAL STANDARDS

- calibrators,
- resistance standards,

● METERS FOR MEASUREMENTS OF NON-ELECTRICAL PARAMETERS

- pyrometers,
- thermal imagers,
- luxmeters.

The Calibration Certificate is a document that presents a relation between the calibration standard of known accuracy and meter indications with associated measurement uncertainties. The calibration standards are normally traceable to the national standard held by the National Metrological Institute.

According to ILAC-G24 „Guidelines for determination of calibration intervals of measuring instruments”, SONEL S.A. recommends periodical metrological inspection of the instruments it manufactures no less frequently than once every 12 months.

For new instruments provided with the Calibration Certificate or Validation Certificate at the factory, recalibration should be performed within 12 months from the date of purchase, however, no later than 24 months from the date of purchase.



ATTENTION!

The person performing the measurements should be absolutely sure about the efficiency of the device being used. Measurements made with an inefficient meter can contribute to an incorrect assessment of the effectiveness of health protection and even human life.

NOTES

SYMBOLS DISPLAYED BY THE METER



Memory



Settings



Return to the main menu



Adding a client, object or measuring point



Entry to client objects



Entry to client edition, object or measurement point with a possibility of changing data



Fast entry deletion on the on-screen keyboard



Deletion of a measurement point, object or client



Measuring Mode



Measurement setup mode



Saving to memory



Help



Exit from the option



Searching for an object or measurement point



There was a limitation of the measuring current to a value lower than that ensuring maximum accuracy



Test leads interchanged



High level of noise (interference), measurement possible with additional uncertainty



High level of noise (interference), measurement possible without defining uncertainty



SONEL S.A.
Wokulskiego 11
58-100 Swidnica
Poland



+48 74 858 38 60
+48 74 858 38 00
fax +48 74 858 38 09

e-mail: export@sonel.pl
www.sonel.pl